

© LITTLE ANVIL

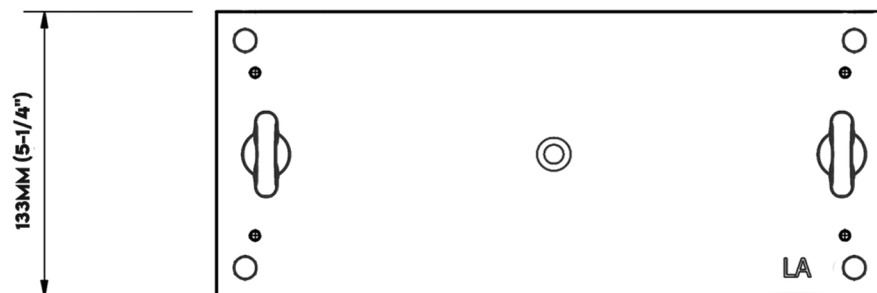

311MM (12-1/4")

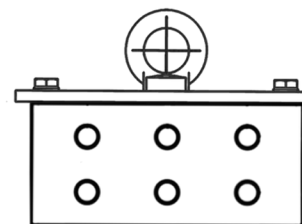
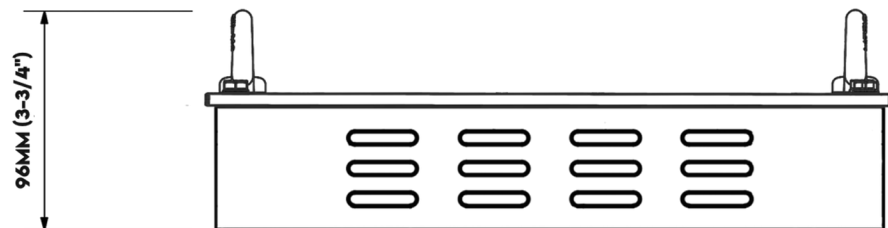

Designed by Neil Morrison	Checked by NM	Approved by NM	Date 05/01/20		
Dimensions in millimetres Limit on untoleranced unmachined dimensions $\pm 0.2\text{mm}$ No decimal place 1mm 1 decimal place $\pm 0.3\text{mm}$ 2 decimal places $\pm 0.1\text{mm}$ General unmachined angular tolerance $\pm 1^\circ$ Tolerance to be non-cumulative			Industrial Adaptable Box Canopy - Assembly		
			Edition 1	Sheet 1/5	

PARTS INVENTORY



© LITTLE ANVIL



CEILING CANOPY WITH GEAR TRAY, EYE BOLTS, RUBBER GROMMET & INTEGRATED EARTH FITTED X 1



ANTI PULL THROUGH X1



CEILING BACKING PLATE WITH INTERGRATED EARTH FITTED X 1



CORD GRIP/S OPTIONAL



HIGH TENSILE BOLTS M6 X 16MM X 4

GEAR TRAY ASSEMBLY - (DRILLING REQUIRED TO SUIT APPLICATION MOUNTING)



WASHER M6 X 4

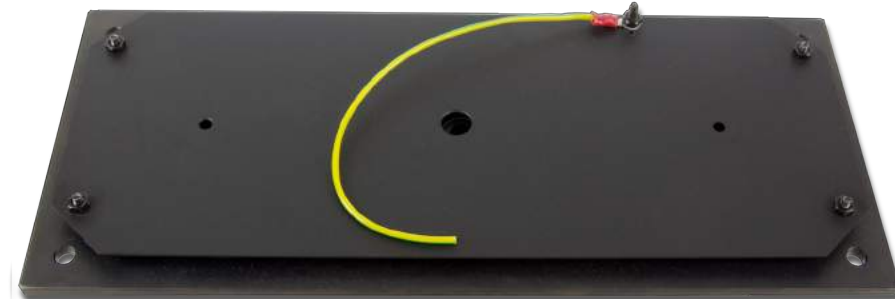

Designed by Neil Morrison	Checked by NM	Approved by NM	Date 05/01/20		
Dimensions in millimetres Limit on untoleranced unmachined dimensions $\pm 0.2\text{mm}$ No decimal place 1mm 1 decimal place $\pm 0.3\text{mm}$ 2 decimal places $\pm 0.1\text{mm}$ General unmachined angular tolerance $\pm 1^\circ$ Tolerance to be non-cumulative			Industrail Adaptable Box Canopy - Assembly		
			Edition 1	Sheet 2/5	

**GEAR TRAY ASSEMBLY EXAMPLE - DRIVER & CONTROLLER
PURCHASED SEPARATELY**



**ADDITIONAL CORD GRIPS - NOT STANDARD
SEE OPTIONS**

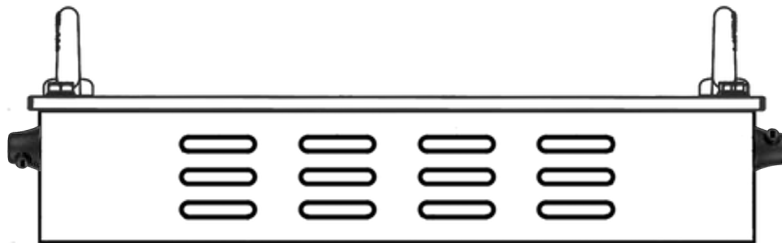

© LITTLE ANVIL

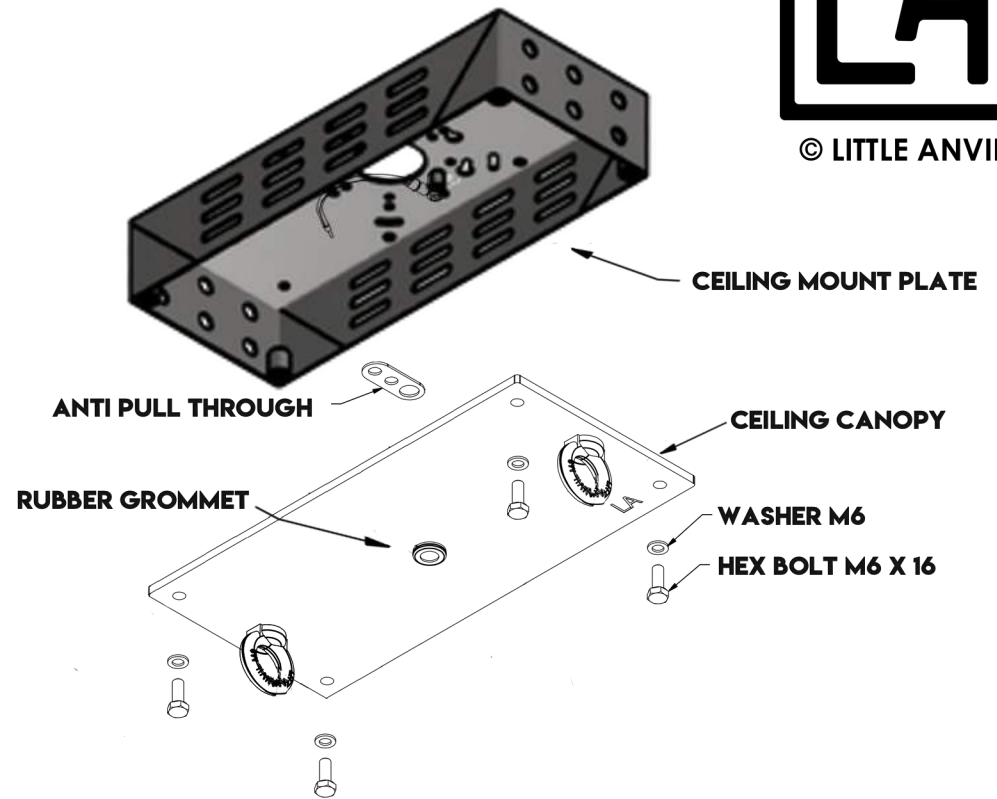

- ENSURE MAINS POWER IS TURNED OFF PRIOR TO ANY WIRING WORK
- PREPARE GEAR TRAY AND MOUNT ELECTRICAL COMPONENTS TO SUIT YOUR APPLICATION
DRILLING MAY BE REQUIRED. COMPONENT MOUNTING HARDWARE IS NOT SUPPLIED
- POSITION AND FIX CEILING MOUNT PLATE TO CEILING - ENSURE ADEQUATE SUPPORT
ANCHORING - MAX 22KGS / 50LBS
- GUIDE ELECTRICAL CABLE THROUGH RUBBER GROMMET AND INTO ANTI PULL THROUGH TO
ENSURE TERMINAL CONNECTIONS ARE PROTECTED FROM PULL OUT
- IF USING CORD GRIPS, GUIDE CABLES THROUGH GRIPS AND TIGHTEN GRUB SCREW
- TERMINATE CABLES AND WIRING INSIDE JUNCTION BOX MAKING SURE NOTHING CAN BE
PULLED OUT
- USE PROVIDED EARTH TERMINATIONS
- ASSEMBLE CEILING CANOPY TO BACKPLATE VIA 4 X M6 BOLTS AND WASHERS
- WARNING - LED DRIVERS REQUIRES FREE AIR VENTILLATION, DO NOT CONCEAL OR COVER
ADAPTABLE BOX CANOPY

Designed by Neil Morrison	Checked by NM	Approved by NM	Date 05/01/20		
Dimensions in millimetres Limit on untoleranced unmachined dimensions $\pm 0.2\text{mm}$ No decimal place 1mm 1 decimal place $\pm 0.3\text{mm}$ 2 decimal places $\pm 0.1\text{mm}$ General unmachined angular tolerance $\pm 1^\circ$ Tolerance to be non-cumulative			Industrial Adaptable Box Canopy - Assembly		
			Edition 1	Sheet 3/5	



© LITTLE ANVIL

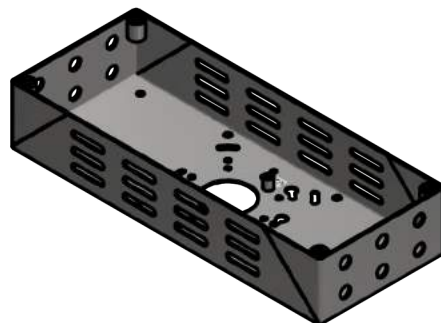
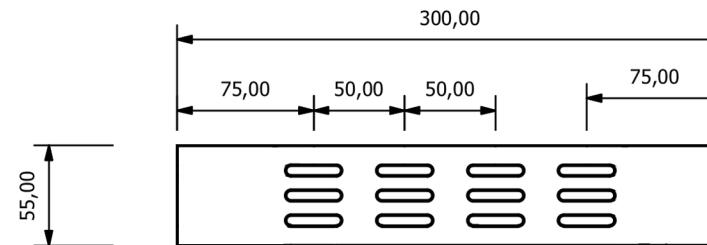
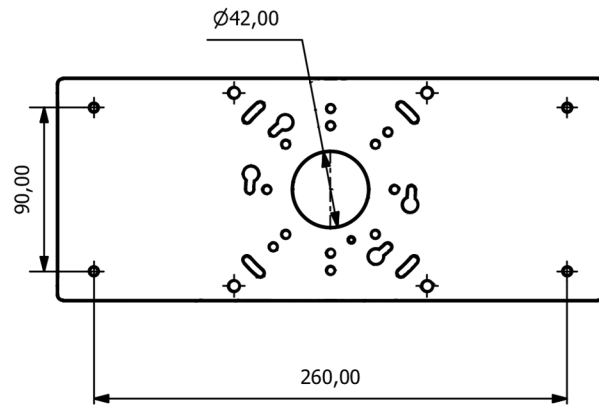
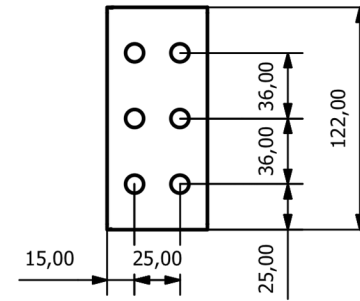
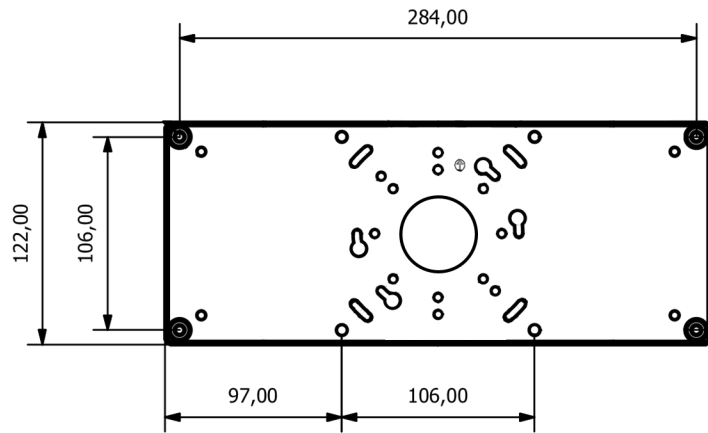

Designed by Neil Morrison	Checked by NM	Approved by NM	Date 05/01/20		
Dimensions in millimetres Limit on untoleranced unmachined dimensions ± 0.2mm No decimal place 1mm 1 decimal place ± 0.3mm 2 decimal places ± 0.1mm General unmachined angular tolerance ±1° Tolerance to be non-cumulative			Industrial Adaptable Box Canopy - Assembly		
			Edition 1	Sheet 4/5	

GEAR TRAY DIMENSIONS



© LITTLE ANVIL

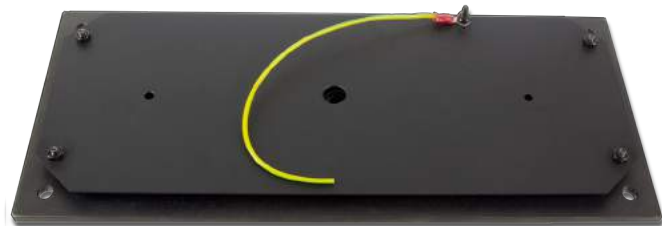
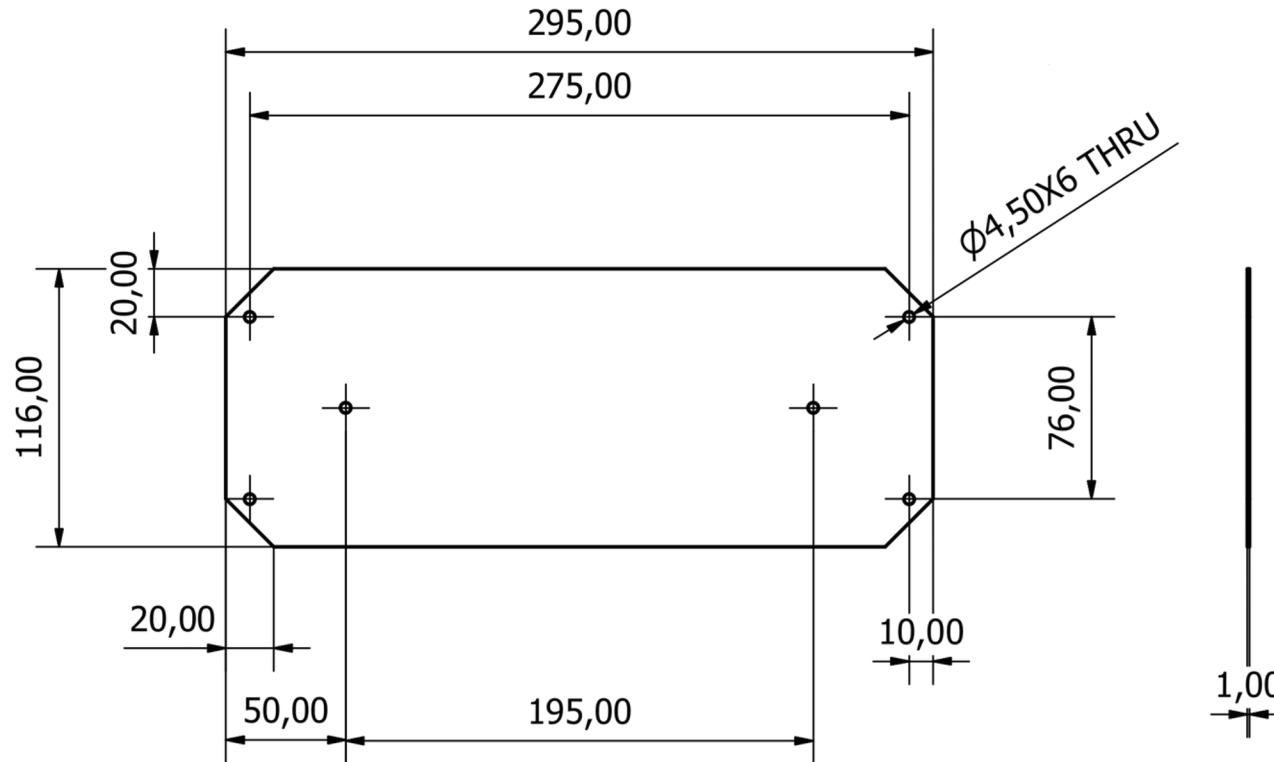

PLEASE NOTE: DRILLING REQUIRED, DRIVER AND OTHER COMPONENT MOUNTING HARDWARE IS NOT SUPPLIED

Designed by Neil Morrison	Checked by NM	Approved by NM	Date 05/01/20		
Dimensions in millimetres Limit on untoleranced unmachined dimensions $\pm 0.2\text{mm}$ No decimal place 1mm 1 decimal place $\pm 0.3\text{mm}$ 2 decimal places $\pm 0.1\text{mm}$ General unmachined angular tolerance $\pm 1^\circ$ Tolerance to be non-cumulative			Industrial Adaptable Box Canopy - Assembly		
			Edition 1	Sheet 5/5	